

EAST 41ST STREET

PLEASE BE ADVISED THAT THE INFORMATION CONTAINED IN THIS PACKAGE HAS NOT BEEN VERIFIED, AND NO EXPRESS REPRESENTATION OR WARRANTY IS MADE NOR IS ANY TO BE IMPLIED AS TO THE ACCURACY THEREOF, AND IT IS SUBMITTED SUBJECT TO ERRORS, OMISSIONS, AND OTHER CONDITIONS.

370 Lexington

SK-013-12-2
 SUITE 1205 Test Fit
 01.04.2023

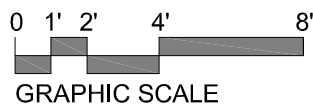

2045 Dill Avenue
 Linden, New Jersey 07036
 908-635-0927
 nsuzansky@nlsarch.com

Natasha L Suzansky Architect LLC

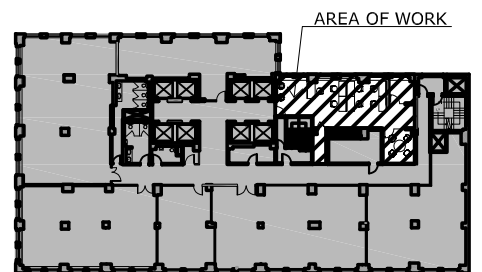
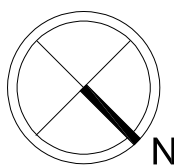

KEY PLAN

N.T.S.

8.5x11